

SCROLL-CHANGE PROCEDURE

A2 MOTION DISPLAY BOARD

- 1** Un-plug the Power Cord from the outlet in order to prevent damage when changing the Scrolls.
- 2** Use the supplied Key to unlock the face of the Display Board and remove it very carefully by pulling out at the bottom, then up from the top (see FIG. A). Set the face aside.
- 3** Remove the Scroll by first lifting the white lip at the top and freeing both tops of the Scroll (see FIG. B), then lift to free each side from the bottom (see FIG. D). Set the Scroll aside for re-packing / return.
- 4** Open the supplied package and carefully remove the new Scroll. Insert the new Scroll by first inserting the gear ends into the bottom (see FIG. D), then lift the white lip and secure the top ends of the Scroll (see FIG. B).
- 5** Be sure to get the paper in between the white guide and the black sensor (top and bottom). (see FIG. C), otherwise the Board will not function properly. (Don't worry if the paper is not "tight" between the 2 rolls of the Scroll, as the unit itself will automatically remove the slack when it is turned on.)
- 6** Put the face back on the Display. Be sure to secure the top first, then the bottom will click in (see FIG. A). (Note that there are 2 metal tabs which slide in to 2 respective slots.) Use the Key to lock.
- 7** Plug in the Power Cord and turn the unit on using the switch on the back of the Display. (It will go through a series of movements in order to orient the graphics; this is normal.)
- 8** Pack old Scroll in the package and return to QuestCom for re-use. Please note that you may be charged a fee if the old Scroll is not returned.

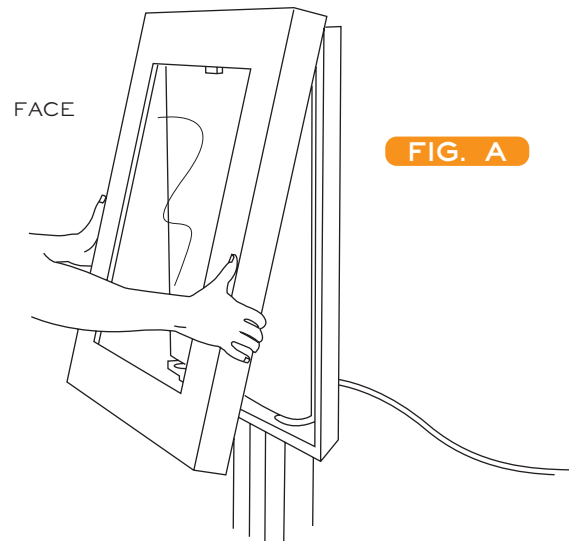

FIG. A

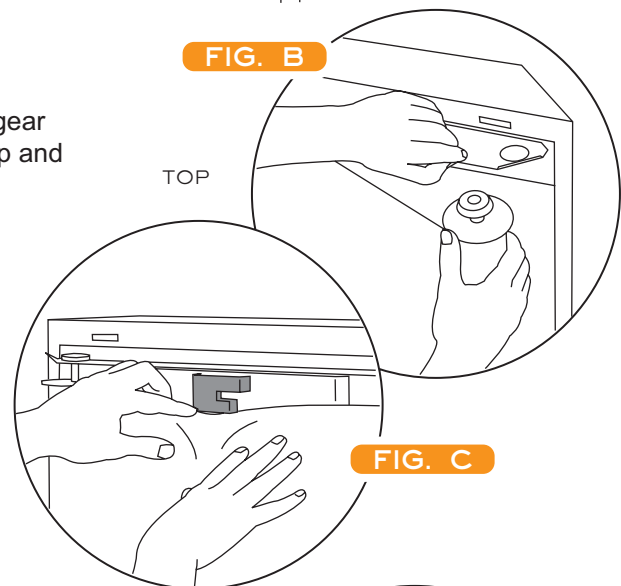

FIG. B

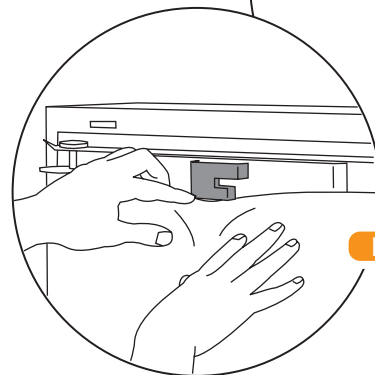

FIG. C

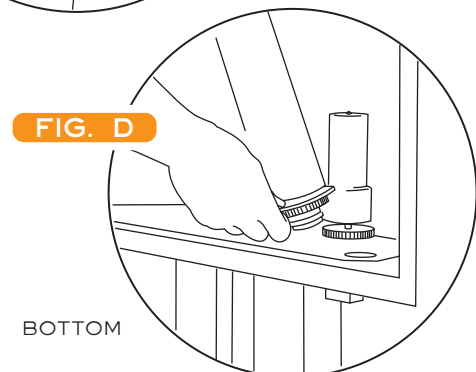

FIG. D

Distributed By:

QuestCom Incorporated
1255 University Ave, Suite 205
Rochester, New York 14607
585.458.0011 ♦ 458.1564 fax
www.questwebstudio.com



QUESTCOM
INCORPORATED